



# INSTRUCTION BULLETIN

No. 9008698  
Machine: S30  
Published: 08-2011  
Rev. 00

**NOTE: DO NOT DISCARD the Parts List from the Instruction Bulletin. Place the Parts List in the appropriate place in the machine manual for future reference. Retaining the Parts List will make it easier to reorder individual parts and will save the cost of ordering an entire kit.**

*NOTE: Numbers in parenthesis ( ) are reference numbers for parts listed in Bill of Materials.*

Installation instructions for **kit number 9008697**

## SYNOPSIS:

This kit contains the parts needed to replace the rear drive motor hoses and fittings on S30 sweepers (serial numbers 000000-002687).

Please follow step-by-step instructions.

## SPECIAL TOOLS / CONSIDERATIONS: NONE

(Estimated time to complete: 3 hours)

## When assembling / disassembling hydraulic components:

1. To prevent contaminants from entering system, thoroughly clean outside of hydraulic components **before** disconnecting hydraulic hoses or fittings, cap disconnected hoses and open ports, and flush hoses and fittings with air, solvent, or hydraulic fluid.
2. Mark hydraulic hoses with locations of where they are attached. Markings make it easier to reconnect hoses to proper locations.
3. Discard all hydraulic fluid drained from the system. Use only new approved hydraulic fluid to replenish hydraulic reservoir.



## PROTECT THE ENVIRONMENT

Please dispose of packaging materials, old machine components, and hazardous fluids in an environmentally safe manner according to local waste disposal regulations.

Always remember to recycle.

## PREPARATION:

1. Park the machine on a clean level surface, turn off the machine, set the parking brake, and remove the key.

**FOR SAFETY: Before leaving or servicing machine, stop on level surface, turn off machine, and remove key.**

2. Completely drain all coolant from the radiator and engine cooling system.
3. Remove the radiator and any other parts necessary to access the propel pump. Set the radiator and all hardware and hose clamps aside.

4. Chock the front and back ends of both front tires, jack up the rear end of the machine, place jack stands underneath the machine, and lower the machine onto the jack stands.

**FOR SAFETY: When servicing machine, block machine tires before jacking machine up. Use a hoist or jack that will support the weight of the machine. Jack machine up at designated locations only. Support machine with jack stands.**

*NOTE: Refer to the MAINTENANCE section in the OPERATOR MANUAL for additional information how to properly jack up the machine.*

**INSTALLATION:**

1. Disconnect the hoses from PORT A and PORT B on the wheel drive motor. Refer to Fig. 1.

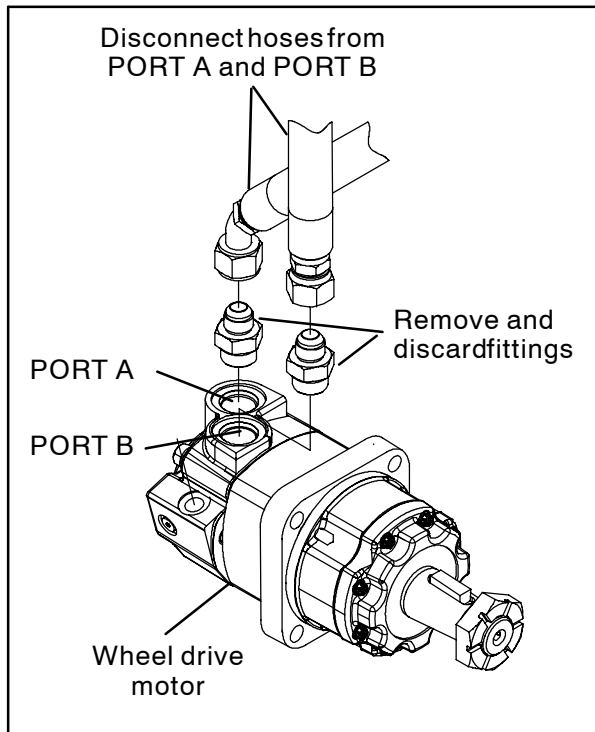

**FIG. 1**

2. Remove the fittings from PORT A and PORT B on the wheel drive motor. Discard both fittings. Refer to Fig. 1.

3. Pull both hoses disconnected from the wheel drive motor up through the back of the machine and disconnect both hoses from the propel pump. Discard both hoses. Refer to Fig. 2.

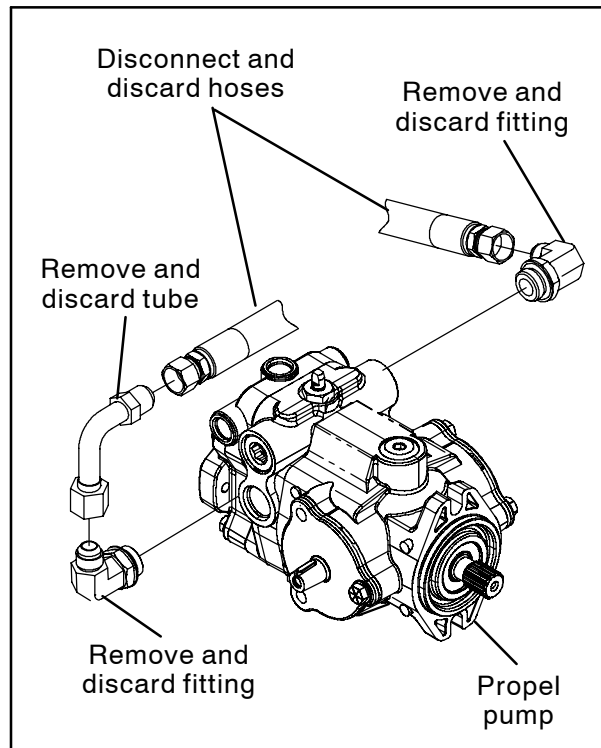

**FIG. 2**

4. Remove the hydraulic tube and fittings from the propel pump. Discard both fittings. Refer to Fig. 2.

5. Install both straight fittings (3) onto the wheel drive motor. Refer to Fig. 3.
6. Install both 90° fittings (1) onto the propel pump. Orient both 90° fittings as shown in Fig. 3.
7. Install the hydraulic tube (2) onto the 90° fitting (1) on the propel pump. Refer to Fig. 3.
8. Connect the 56" hydraulic hose (5) to the hydraulic tube (2).
9. Route the 56" hydraulic hose (5) down to the wheel drive motor and connect the hydraulic hose to PORT A on the wheel drive motor. Refer to Fig. 3.
10. Connect the 46" hydraulic hose (4) to the straight fitting (1) located on the other side of the propel pump. Refer to Fig. 3.
11. Route the 46" hydraulic hose (4) down to the wheel drive motor and connect the hydraulic hose to PORT B on the wheel drive motor. Refer to Fig. 3.

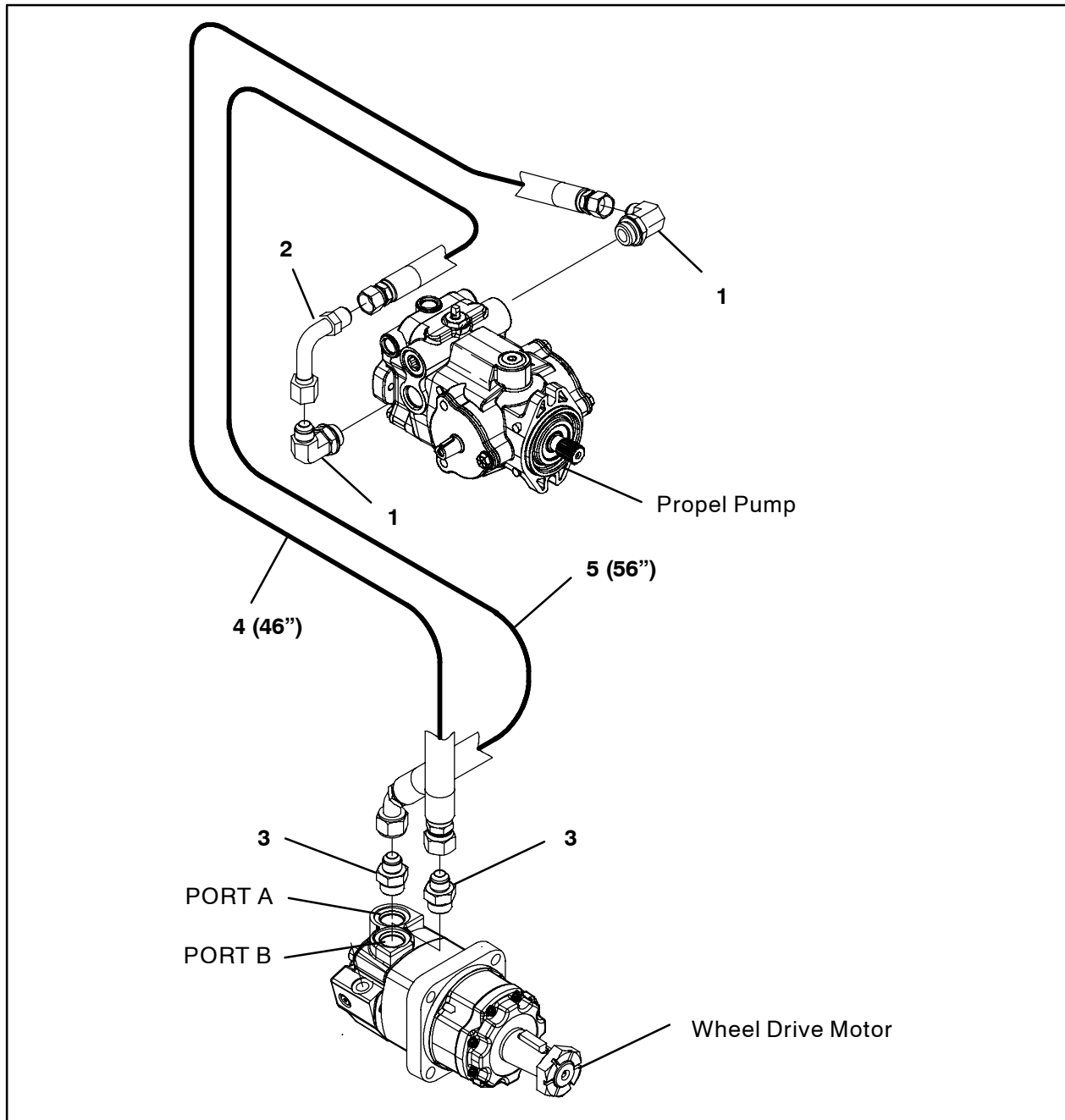

**FIG. 3**

12. Raise the rear end of the machine off the jack stands, remove the jack stands from underneath the machine, and lower the machine to the ground.
13. Reinstall the radiator and all other parts removed to access the propel pump.
14. Refill the engine coolant system.
15. Check the hydraulic fluid level and add hydraulic fluid to the system as necessary.
16. Start and operate the machine. Observe the newly installed hoses and fitting for leaks.
17. Turn off the machine.
18. Check the level in the engine coolant system. Add coolant as necessary.

**Bill Of Materials For Hose Kit, Rear Drive, Replmt - 9008697**

	<b>Ref.</b>	<b>Tennant Part No.</b>	<b>Description</b>	<b>Qty.</b>
▽		9008697	Hose Kit, Rear Drive, Replmt	
▲	1	762469	Fitting, Hyd, E90, FM10/OM12	2
▲	2	1065781	Tube, Hyd, Pump, Rear Drive, FF10/FM10	1
▲	3	762468	Fitting, Hyd, Str, FM10/OM12	2
▲	4	1065452	Hose, Hyd, Spcl, FF10STR/FF10STR, 046.0	1
▲	5	1065453	Hose, Hyd, Spcl, FF10E45/FF10STR, 056.0	1

TENNANT COMPANY  
P. O. Box 1452  
Minneapolis, MN 55440-1452